

3D View

Type 6 Front

Top View

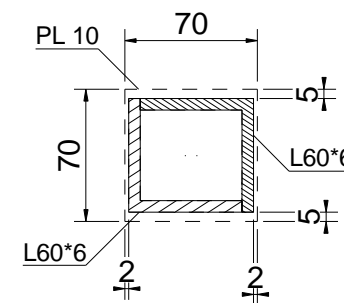
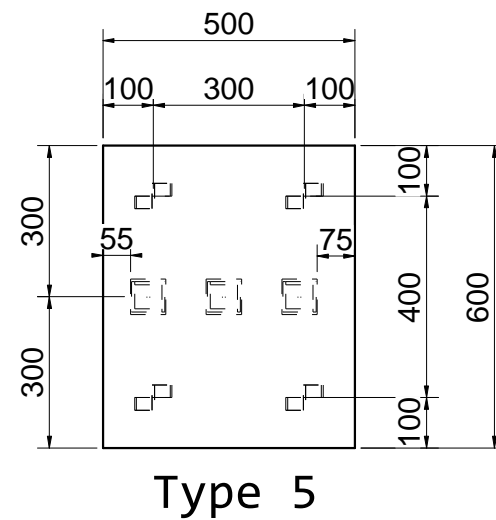
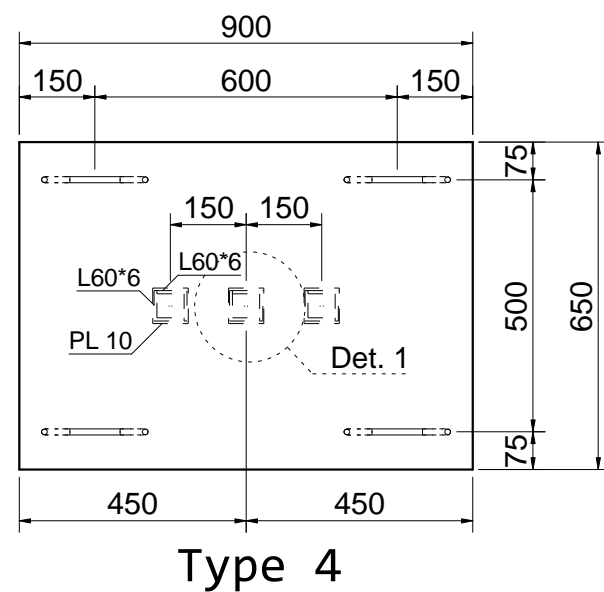

Det 1  
Shear Keys are  
composed of two  
angles and an endplate

- There are 6 different Embedded steel plates
- Rebars , rag bolts, plates and profiles have been welded to the back at the given locations
- Assume reasonable values for information not provided

Tutorial: <https://youtu.be/npf12pVSxNE>

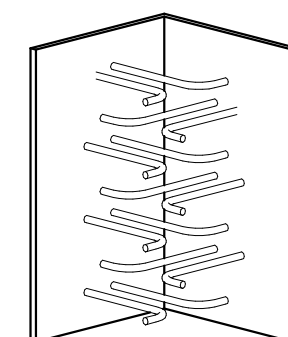
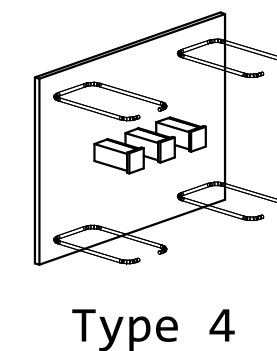
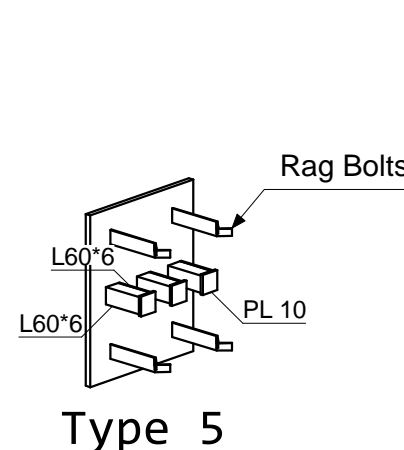
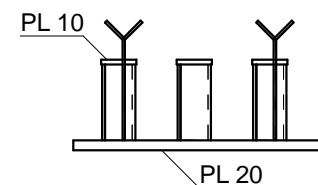
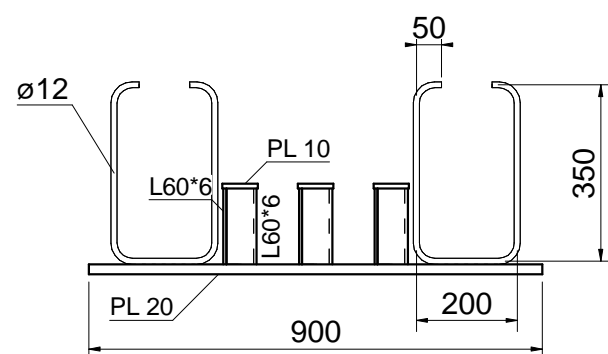

Staggered Placement  
Type 6

Top View

3D View